

INSTALLATION INSTRUCTIONS

DESCRIPTION: Front Axle Slider Kit

PART NUMBER: B3L-F51B0-V0

MODEL: '17~ YZF-R1; '17~ YZF-R6



WARNING

Please read and understand these instructions completely before installation to avoid possible injury, or damage to the accessory or vehicle.

NOTICE:

Installation of this kit requires a torque wrench. This installation should be performed by an authorized Yamaha dealer or a qualified mechanic.

WARRANTY INFORMATION:

In the United States, see your authorized Yamaha dealer for a copy of the Yamaha *Genuine Parts and Accessories Limited Warranty*

DEALER OR INSTALLER:

These instructions contain important information for future reference and *must* be given to the customer.

PARTS LIST:

| No. | Part Number | Description | Qty |
|-----|--------------|-----------------------|-----|
| -- | B3L-F51B0-V0 | Front Axle Slider Kit | -- |
| ① | * | Left Slider | 1 |
| ② | * | Right Slider | 1 |
| ③ | * | Slider Bolt | 2 |
| ④ | * | Slider Rod | 1 |

* Part supplied with kit only and not available separately.

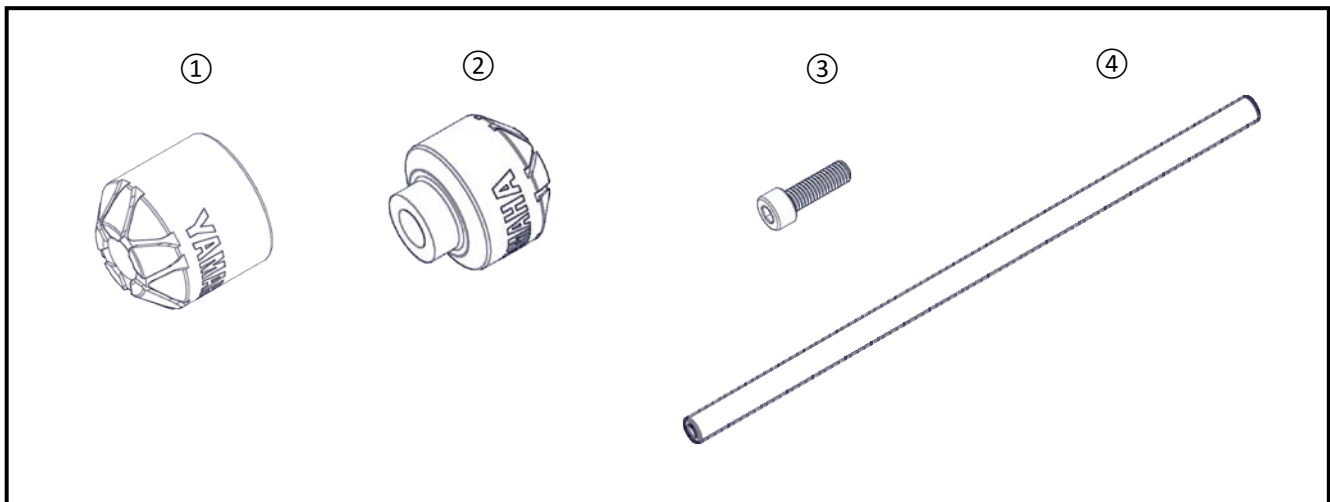
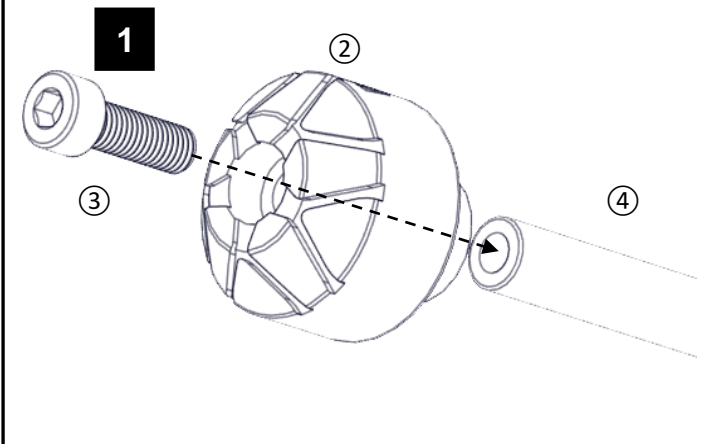

Fig. 1



PREPARATION:

- Stand motorcycle on a secure and level surface.
- Clean all mounting surfaces before beginning installation.

INSTALLATION:

- 1** Install the (3) Slider Bolt through the Right Slider (2) and thread into the (4) Slider Rod as shown in Fig. 1.
- 2** Install the assembled (4)+(3)+(2) slider into the center hole of the front axle bolt. **Note:** You do not have to disassemble anything to install this kit.
- 3** Install the (1) Left Slider on to the (4) Slider Rod. Thread a (3) Slider Bolt through the center of the Left Slider and into the Slider Rod. Hold the Right Side ((4)+(3)+(2)) and Torque bolt to 10 Nm (1.0 m-kgf, 7.2 ft-lbf). See Fig. 2.

MAINTENANCE:

Periodically, check torque on all hardware. If loose hardware is found, re-torque to specification.

CARE AND CLEANING:

Clean sliders with a clean soft cloth and mild soap and water. Rinse and dry.

CUSTOMER SERVICE:

For further information see your Yamaha dealer.

ESTIMATED TIME TO INSTALL: 0.1 HRS.

Fig. 2

